

## Venta de Terreno Finca en Chorrera, 8.4 hectáreas

### Descripción



Ubicación: En el área de los mortales, El Espino, Chorrera, Panamá Oeste

Metraje: 84,000m<sup>2</sup> (8.4 hectáreas)

Descripción:

- 300 metros frente a calle asfaltada en esquina con calle secundaria
- A 15 minutos de la Carretera Interamericana
- Cerca del gran desarrollo residencial de Panamá Oeste
- Luz, agua y señal telefónica
- Colinda con río Caimitillo con buen caudal
- Ideal para proyectos de desarrollos: residencial, turístico, hotelero o centro recreativo

Precio de venta: \$325,000.00

Precio x m<sup>2</sup>: \$3.80

-----  
Farm in Chorrera, 8.4 hectares

Location: In the area of the mortals, El Espino, Chorrera, Panama Oeste

Footage: 84,000m<sup>2</sup> (8.4 hectares)

Description:

- 300 meters in front of a paved street on the corner of a secondary street
- 15 minutes from the Inter-American Highway
- Near the large residential development of Panama Oeste
- Electricity, water and telephone signal
- Adjacent to the Caimitillo River with good flow
- Ideal for development projects: residential, tourist, hotel or recreational center

Sale price: \$325,000.00

Price per m<sup>2</sup>: \$3.80

|                        |                                |
|------------------------|--------------------------------|
| <b>ID de Propiedad</b> | <a href="#">FPANJ31.8.21.1</a> |
| <b>Área de Terreno</b> | 84000 mt <sup>2</sup>          |
| <b>Precio</b>          | 325,000.00                     |
| <b>Precio por Área</b> | 3.80                           |

## Ubicación



## Agente



**Jose Manuel Varela**

[+50766150060 \(Llamar\)](tel:+50766150060)

[+50766150060 \(WhatsApp\)](tel:+50766150060)

[jose@imperial.com.pa](mailto:jose@imperial.com.pa)

+50766150060

+5073965060

## Fotos











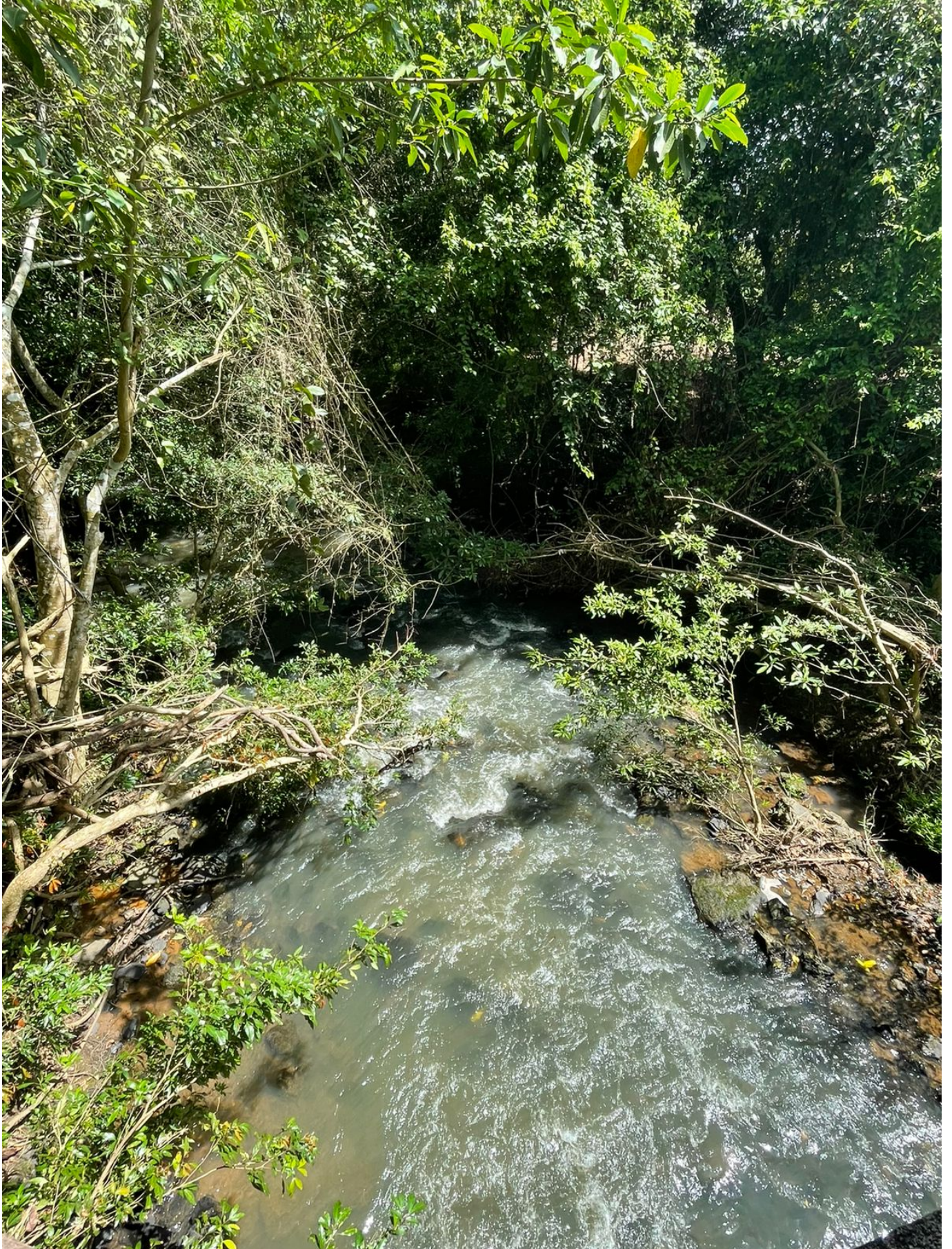























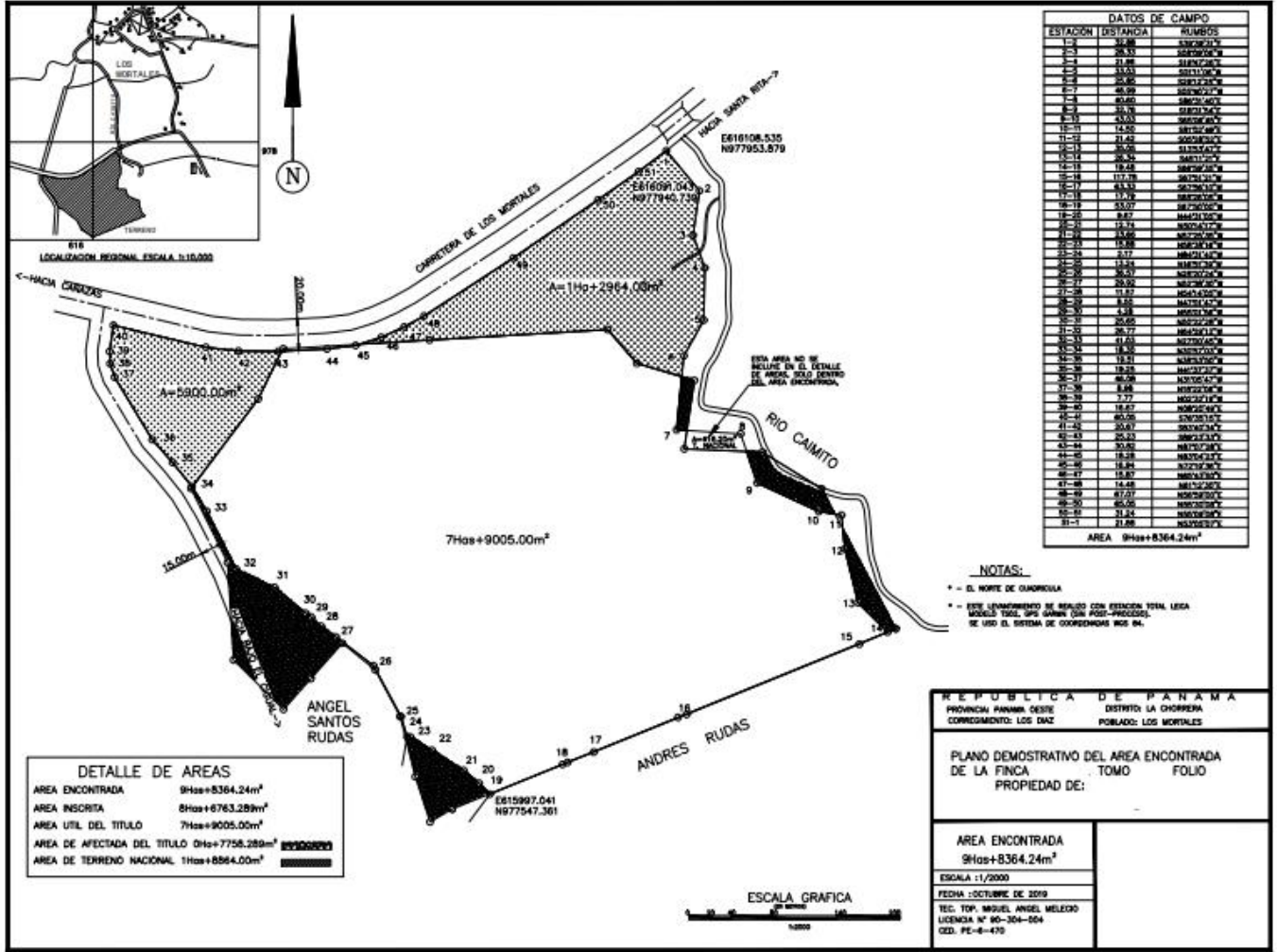

| DATOS DE CAMPO |           |               |
|----------------|-----------|---------------|
| ESTACION       | LOS/ANCHO | REMBOS        |
| 1-2            | 3.87      | SEPTENTRIONAL |
| 2-3            | 28.33     | SEPTENTRIONAL |
| 3-4            | 11.85     | SEPTENTRIONAL |
| 4-5            | 28.80     | SEPTENTRIONAL |
| 5-6            | 28.80     | SEPTENTRIONAL |
| 6-7            | 60.80     | SEPTENTRIONAL |
| 7-8            | 28.78     | SEPTENTRIONAL |
| 8-9            | 53.03     | SEPTENTRIONAL |
| 9-10           | 14.50     | SEPTENTRIONAL |
| 10-11          | 21.63     | SEPTENTRIONAL |
| 11-12          | 26.20     | SEPTENTRIONAL |
| 12-13          | 28.34     | SEPTENTRIONAL |
| 13-14          | 18.48     | SEPTENTRIONAL |
| 14-15          | 177.78    | SEPTENTRIONAL |
| 15-16          | 83.33     | SEPTENTRIONAL |
| 16-17          | 14.78     | SEPTENTRIONAL |
| 17-18          | 53.07     | SEPTENTRIONAL |
| 18-19          | 3.87      | SEPTENTRIONAL |
| 19-20          | 18.78     | SEPTENTRIONAL |
| 20-21          | 13.88     | SEPTENTRIONAL |
| 21-22          | 15.77     | SEPTENTRIONAL |
| 22-23          | 13.88     | SEPTENTRIONAL |
| 23-24          | 13.88     | SEPTENTRIONAL |
| 24-25          | 13.88     | SEPTENTRIONAL |
| 25-26          | 13.88     | SEPTENTRIONAL |
| 26-27          | 13.88     | SEPTENTRIONAL |
| 27-28          | 13.88     | SEPTENTRIONAL |
| 28-29          | 13.88     | SEPTENTRIONAL |
| 29-30          | 13.88     | SEPTENTRIONAL |
| 30-31          | 13.88     | SEPTENTRIONAL |
| 31-32          | 13.88     | SEPTENTRIONAL |
| 32-33          | 13.88     | SEPTENTRIONAL |
| 33-34          | 13.88     | SEPTENTRIONAL |
| 34-35          | 13.88     | SEPTENTRIONAL |
| 35-36          | 13.88     | SEPTENTRIONAL |
| 36-37          | 13.88     | SEPTENTRIONAL |
| 37-38          | 13.88     | SEPTENTRIONAL |
| 38-39          | 13.88     | SEPTENTRIONAL |
| 39-40          | 13.88     | SEPTENTRIONAL |
| 40-41          | 13.88     | SEPTENTRIONAL |
| 41-42          | 13.88     | SEPTENTRIONAL |
| 42-43          | 13.88     | SEPTENTRIONAL |
| 43-44          | 13.88     | SEPTENTRIONAL |
| 44-45          | 13.88     | SEPTENTRIONAL |
| 45-46          | 13.88     | SEPTENTRIONAL |
| 46-47          | 13.88     | SEPTENTRIONAL |
| 47-48          | 13.88     | SEPTENTRIONAL |
| 48-49          | 13.88     | SEPTENTRIONAL |
| 49-50          | 13.88     | SEPTENTRIONAL |
| 50-51          | 13.88     | SEPTENTRIONAL |
| 51-52          | 13.88     | SEPTENTRIONAL |
| 52-53          | 13.88     | SEPTENTRIONAL |
| 53-54          | 13.88     | SEPTENTRIONAL |
| 54-55          | 13.88     | SEPTENTRIONAL |
| 55-56          | 13.88     | SEPTENTRIONAL |
| 56-57          | 13.88     | SEPTENTRIONAL |
| 57-58          | 13.88     | SEPTENTRIONAL |
| 58-59          | 13.88     | SEPTENTRIONAL |
| 59-60          | 13.88     | SEPTENTRIONAL |
| 60-61          | 13.88     | SEPTENTRIONAL |
| 61-62          | 13.88     | SEPTENTRIONAL |
| 62-63          | 13.88     | SEPTENTRIONAL |
| 63-64          | 13.88     | SEPTENTRIONAL |
| 64-65          | 13.88     | SEPTENTRIONAL |
| 65-66          | 13.88     | SEPTENTRIONAL |
| 66-67          | 13.88     | SEPTENTRIONAL |
| 67-68          | 13.88     | SEPTENTRIONAL |
| 68-69          | 13.88     | SEPTENTRIONAL |
| 69-70          | 13.88     | SEPTENTRIONAL |
| 70-71          | 13.88     | SEPTENTRIONAL |
| 71-72          | 13.88     | SEPTENTRIONAL |
| 72-73          | 13.88     | SEPTENTRIONAL |
| 73-74          | 13.88     | SEPTENTRIONAL |
| 74-75          | 13.88     | SEPTENTRIONAL |
| 75-76          | 13.88     | SEPTENTRIONAL |
| 76-77          | 13.88     | SEPTENTRIONAL |
| 77-78          | 13.88     | SEPTENTRIONAL |
| 78-79          | 13.88     | SEPTENTRIONAL |
| 79-80          | 13.88     | SEPTENTRIONAL |
| 80-81          | 13.88     | SEPTENTRIONAL |
| 81-82          | 13.88     | SEPTENTRIONAL |
| 82-83          | 13.88     | SEPTENTRIONAL |
| 83-84          | 13.88     | SEPTENTRIONAL |
| 84-85          | 13.88     | SEPTENTRIONAL |
| 85-86          | 13.88     | SEPTENTRIONAL |
| 86-87          | 13.88     | SEPTENTRIONAL |
| 87-88          | 13.88     | SEPTENTRIONAL |
| 88-89          | 13.88     | SEPTENTRIONAL |
| 89-90          | 13.88     | SEPTENTRIONAL |
| 90-91          | 13.88     | SEPTENTRIONAL |
| 91-92          | 13.88     | SEPTENTRIONAL |
| 92-93          | 13.88     | SEPTENTRIONAL |
| 93-94          | 13.88     | SEPTENTRIONAL |
| 94-95          | 13.88     | SEPTENTRIONAL |
| 95-96          | 13.88     | SEPTENTRIONAL |
| 96-97          | 13.88     | SEPTENTRIONAL |
| 97-98          | 13.88     | SEPTENTRIONAL |
| 98-99          | 13.88     | SEPTENTRIONAL |
| 99-100         | 13.88     | SEPTENTRIONAL |
| 100-101        | 13.88     | SEPTENTRIONAL |
| 101-102        | 13.88     | SEPTENTRIONAL |
| 102-103        | 13.88     | SEPTENTRIONAL |
| 103-104        | 13.88     | SEPTENTRIONAL |
| 104-105        | 13.88     | SEPTENTRIONAL |
| 105-106        | 13.88     | SEPTENTRIONAL |
| 106-107        | 13.88     | SEPTENTRIONAL |
| 107-108        | 13.88     | SEPTENTRIONAL |
| 108-109        | 13.88     | SEPTENTRIONAL |
| 109-110        | 13.88     | SEPTENTRIONAL |
| 110-111        | 13.88     | SEPTENTRIONAL |
| 111-112        | 13.88     | SEPTENTRIONAL |
| 112-113        | 13.88     | SEPTENTRIONAL |
| 113-114        | 13.88     | SEPTENTRIONAL |
| 114-115        | 13.88     | SEPTENTRIONAL |
| 115-116        | 13.88     | SEPTENTRIONAL |
| 116-117        | 13.88     | SEPTENTRIONAL |
| 117-118        | 13.88     | SEPTENTRIONAL |
| 118-119        | 13.88     | SEPTENTRIONAL |
| 119-120        | 13.88     | SEPTENTRIONAL |
| 120-121        | 13.88     | SEPTENTRIONAL |
| 121-122        | 13.88     | SEPTENTRIONAL |
| 122-123        | 13.88     | SEPTENTRIONAL |
| 123-124        | 13.88     | SEPTENTRIONAL |
| 124-125        | 13.88     | SEPTENTRIONAL |
| 125-126        | 13.88     | SEPTENTRIONAL |
| 126-127        | 13.88     | SEPTENTRIONAL |
| 127-128        | 13.88     | SEPTENTRIONAL |
| 128-129        | 13.88     | SEPTENTRIONAL |
| 129-130        | 13.88     | SEPTENTRIONAL |
| 130-131        | 13.88     | SEPTENTRIONAL |
| 131-132        | 13.88     | SEPTENTRIONAL |
| 132-133        | 13.88     | SEPTENTRIONAL |
| 133-134        | 13.88     | SEPTENTRIONAL |
| 134-135        | 13.88     | SEPTENTRIONAL |
| 135-136        | 13.88     | SEPTENTRIONAL |
| 136-137        | 13.88     | SEPTENTRIONAL |
| 137-138        | 13.88     | SEPTENTRIONAL |
| 138-139        | 13.88     | SEPTENTRIONAL |
| 139-140        | 13.88     | SEPTENTRIONAL |
| 140-141        | 13.88     | SEPTENTRIONAL |
| 141-142        | 13.88     | SEPTENTRIONAL |
| 142-143        | 13.88     | SEPTENTRIONAL |
| 143-144        | 13.88     | SEPTENTRIONAL |
| 144-145        | 13.88     | SEPTENTRIONAL |
| 145-146        | 13.88     | SEPTENTRIONAL |
| 146-147        | 13.88     | SEPTENTRIONAL |
| 147-148        | 13.88     | SEPTENTRIONAL |
| 148-149        | 13.88     | SEPTENTRIONAL |
| 149-150        | 13.88     | SEPTENTRIONAL |
| 150-151        | 13.88     | SEPTENTRIONAL |
| 151-152        | 13.88     | SEPTENTRIONAL |
| 152-153        | 13.88     | SEPTENTRIONAL |
| 153-154        | 13.88     | SEPTENTRIONAL |
| 154-155        | 13.88     | SEPTENTRIONAL |
| 155-156        | 13.88     | SEPTENTRIONAL |
| 156-157        | 13.88     | SEPTENTRIONAL |
| 157-158        | 13.88     | SEPTENTRIONAL |
| 158-159        | 13.88     | SEPTENTRIONAL |
| 159-160        | 13.88     | SEPTENTRIONAL |
| 160-161        | 13.88     | SEPTENTRIONAL |
| 161-162        | 13.88     | SEPTENTRIONAL |
| 162-163        | 13.88     | SEPTENTRIONAL |
| 163-164        | 13.88     | SEPTENTRIONAL |
| 164-165        | 13.88     | SEPTENTRIONAL |
| 165-166        | 13.88     | SEPTENTRIONAL |
| 166-167        | 13.88     | SEPTENTRIONAL |
| 167-168        | 13.88     | SEPTENTRIONAL |
| 168-169        | 13.88     | SEPTENTRIONAL |
| 169-170        | 13.88     | SEPTENTRIONAL |
| 170-171        | 13.88     | SEPTENTRIONAL |
| 171-172        | 13.88     | SEPTENTRIONAL |
| 172-173        | 13.88     | SEPTENTRIONAL |
| 173-174        | 13.88     | SEPTENTRIONAL |
| 174-175        | 13.88     | SEPTENTRIONAL |
| 175-176        | 13.88     | SEPTENTRIONAL |
| 176-177        | 13.88     | SEPTENTRIONAL |
| 177-178        | 13.88     | SEPTENTRIONAL |
| 178-179        | 13.88     | SEPTENTRIONAL |
| 179-180        | 13.88     | SEPTENTRIONAL |
| 180-181        | 13.88     | SEPTENTRIONAL |
| 181-182        | 13.88     | SEPTENTRIONAL |
| 182-183        | 13.88     | SEPTENTRIONAL |
| 183-184        | 13.88     | SEPTENTRIONAL |
| 184-185        | 13.88     | SEPTENTRIONAL |
| 185-186        | 13.88     | SEPTENTRIONAL |
| 186-187        | 13.88     | SEPTENTRIONAL |
| 187-188        | 13.88     | SEPTENTRIONAL |
| 188-189        | 13.88     | SEPTENTRIONAL |
| 189-190        | 13.88     | SEPTENTRIONAL |
| 190-191        | 13.88     | SEPTENTRIONAL |
| 191-192        | 13.88     | SEPTENTRIONAL |
| 192-193        | 13.88     | SEPTENTRIONAL |
| 193-194        | 13.88     | SEPTENTRIONAL |
| 194-195        | 13.88     | SEPTENTRIONAL |
| 195-196        | 13.88     | SEPTENTRIONAL |
| 196-197        | 13.88     | SEPTENTRIONAL |
| 197-198        | 13.88     | SEPTENTRIONAL |
| 198-199        | 13.88     | SEPTENTRIONAL |
| 199-200        | 13.88     | SEPTENTRIONAL |
| 200-201        | 13.88     | SEPTENTRIONAL |
| 201-202        | 13.88     | SEPTENTRIONAL |
| 202-203        | 13.88     | SEPTENTRIONAL |
| 203-204        | 13.88     | SEPTENTRIONAL |
| 204-205        | 13.88     | SEPTENTRIONAL |
| 205-206        | 13.88     | SEPTENTRIONAL |
| 206-207        | 13.88     | SEPTENTRIONAL |
| 207-208        | 13.88     | SEPTENTRIONAL |
| 208-209        | 13.88     | SEPTENTRIONAL |
| 209-210        | 13.88     | SEPTENTRIONAL |
| 210-211        | 13.88     | SEPTENTRIONAL |
| 211-212        | 13.88     | SEPTENTRIONAL |
| 212-213        | 13.88     | SEPTENTRIONAL |
| 213-214        | 13.88     | SEPTENTRIONAL |
| 214-215        | 13.88     | SEPTENTRIONAL |
| 215-216        | 13.88     | SEPTENTRIONAL |
| 216-217        | 13.88     | SEPTENTRIONAL |
| 217-218        | 13.88     | SEPTENTRIONAL |
| 218-219        | 13.88     | SEPTENTRIONAL |
| 219-220        | 13.88     | SEPTENTRIONAL |
| 220-221        | 13.88     | SEPTENTRIONAL |
| 221-222        | 13.88     | SEPTENTRIONAL |
| 222-223        | 13.88     | SEPTENTRIONAL |
| 223-224        | 13.88     | SEPTENTRIONAL |
| 224-225        | 13.88     | SEPTENTRIONAL |
| 225-226        | 13.88     | SEPTENTRIONAL |
| 226-227        | 13.88     | SEPTENTRIONAL |
| 227-228        | 13.88     | SEPTENTRIONAL |
| 228-229        | 13.88     | SEPTENTRIONAL |
| 229-230        | 13.88     | SEPTENTRIONAL |
| 230-231        | 13.88     | SEPTENTRIONAL |
| 231-232        | 13.88     | SEPTENTRIONAL |
| 232-233        | 13.88     | SEPTENTRIONAL |
| 233-234        | 13.88     | SEPTENTRIONAL |
| 234-235        | 13.88     | SEPTENTRIONAL |
| 235-236        | 13.88     | SEPTENTRIONAL |
| 236-237        | 13.88     | SEPTENTRIONAL |
| 237-238        | 13.88     | SEPTENTRIONAL |
| 238-239        | 13.88     | SEPTENTRIONAL |
| 239-240        | 13.88     | SEPTENTRIONAL |
| 240-241        | 13.88     | SEPTENTRIONAL |
| 241-242        | 13.88     | SEPTENTRIONAL |
| 242-243        | 13.88     | SEPTENTRIONAL |
| 243-244        | 13.88     | SEPTENTRIONAL |
| 244-245        | 13.88     | SEPTENTRIONAL |
| 245-246        | 13.88     | SEPTENTRIONAL |
| 246-247        | 13.88     | SEPTENTRIONAL |
| 247-248        | 13.88     | SEPTENTRIONAL |
| 248-249        | 13.88     | SEPTENTRIONAL |
| 249-250        | 13.88     | SEPTENTRIONAL |
| 250-251        | 13.88     | SEPTENTRIONAL |
| 251-252        | 13.88     | SEPTENTRIONAL |
| 252-253        | 13.88     | SEPTENTRIONAL |
| 253-254        | 13.88     | SEPTENTRIONAL |
| 254-255        | 13.88     | SEPTENTRIONAL |
| 255-256        | 13.88     | SEPTENTRIONAL |
| 256-257        | 13.88     | SEPTENTRIONAL |
| 257-258        | 13.88     | SEPTENTRIONAL |
| 258-259        | 13.88     | SEPTENTRIONAL |
| 259-260        | 13.88     | SEPTENTRIONAL |
| 260-261        | 13.88     | SEPTENTRIONAL |
| 261-262        | 13.88     | SEPTENTRIONAL |
| 262-263        | 13.88     | SEPTENTRIONAL |
| 263-264        | 13.88     | SEPTENTRIONAL |
| 264-265        | 13.88     | SEPTENTRIONAL |
| 265-266        | 13.88     | SEPTENTRIONAL |
| 266-267        | 13.88     | SEPTENTRIONAL |
| 267-268        | 13.88     | SEPTENTRIONAL |
| 268-269        | 13.88     | SEPTENTRIONAL |
| 269-270        | 13.88     | SEPTENTRIONAL |
| 270-271        | 13.88     | SEPTENTRIONAL |
| 271-272        | 13.88     | SEPTENTRIONAL |
| 272-273        | 13.88     | SEPTENTRIONAL |
| 273-274        | 13.88     | SEPTENTRIONAL |
| 274-275        | 13.88     | SEPTENTRIONAL |
| 275-276        | 13.88     | SEPTENTRIONAL |
| 276-277        | 13.88     | SEPTENTRIONAL |
| 277-278        | 13.88     | SEPTENTRIONAL |
| 278-279        | 13.88     | SEPTENTRIONAL |
| 279-280        | 13.88     | SEPTENTRIONAL |
| 280-281        | 13.88     | SEPTENTRIONAL |
| 281-282        | 13.88     | SEPTENTRIONAL |
| 282-283        | 13.88     | SEPTENTRIONAL |
| 283-284        | 13.88     | SEPTENTRIONAL |
| 284-285        | 13.88     | SEPTENTRIONAL |
| 285-286        | 13.88     | SEPTENTRIONAL |
| 286-287        | 13.88     | SEPTENTRIONAL |
| 287-288        | 13.88     | SEPTENTRIONAL |
| 288-289        | 13.88     | SEPTENTRIONAL |
| 289-290        | 13.88     | SEPTENTRIONAL |
| 290-291        | 13.88     | SEPTENTRIONAL |
| 291-292        | 13.88     | SEPTENTRIONAL |
| 292-293        | 13.88     | SEPTENTRIONAL |
| 293-294        | 13.88     | SEPTENTRIONAL |
| 294-295        | 13.88     | SEPTENTRIONAL |
| 295-296        | 13.88     | SEPTENTRIONAL |
| 296-297        | 13.88     | SEPTENTRIONAL |
| 297-298        | 13.88     | SEPTENTRIONAL |
| 298-299        | 13.88     | SEPTENTRIONAL |
| 299-300        | 13.88     | SEPTENTRIONAL |
| 300-301        | 13.88     | SEPTENTRIONAL |
| 301-302        | 13.88     | SEPTENTRIONAL |
| 302-303        | 13.88     | SEPTENTRIONAL |
| 303-304        | 13.88     | SEPTENTRIONAL |
| 304-305        | 13.88     | SEPTENTRIONAL |
| 305-306        | 13.88     | SEPTENTRIONAL |
| 306-307        | 13.88     | SEPTENTRIONAL |
| 307-308        | 13.88     | SEPTENTRIONAL |
| 308-309        | 13.88     | SEPTENTRIONAL |
| 309-310        | 13.88     | SEPTENTRIONAL |
| 310-311        | 13.88     | SEPTENTRIONAL |
| 311-312        | 13.88     | SEPTENTRIONAL |
| 312-313        | 13.88     | SEPTENTRIONAL |
| 313-314        | 13.88     | SEPTENTRIONAL |
| 314-315        | 13.88     | SEPTENTRIONAL |
| 315-316        | 13.88     | SEPTENTRIONAL |
| 316-317        | 13.88     | SEPTENTRIONAL |
| 317-318        | 13.88     | SEPTENTRIONAL |
| 318-319        | 13.88     | SEPTENTRIONAL |
| 319-320        | 13.88     |               |

