

Office for rent in Costa del Este, Times Square Center Tower, 862m2

Descripción



Location: Ave. Costa del Sol, diagonal to Town Center, Costa del Este

Building: Times Square Center

Footage: 862m2

Description:

- Work in gray
- Full floor
- 4 bathrooms
- Maintenance fee of \$2.00 x m2
- 15 large parking spaces

Building Description:

- Entrance access to the building with Face recognition system
- Security cameras throughout the building
- Outdoor terrace area with landscaping and lighting
- Offices with panoramic views
- Avant-garde architectural design
- 6 high-speed elevators in the tower with a capacity of 24 passengers
- 2 high-speed elevators for the commercial area
- Total power plant
- Thirty levels of offices
- 6 parking levels
- Ample parking
- Each office has its own independent provision for its air conditioning

The TIMES SQUARE CENTER tower is located in one of the best points in the Costa del Este area, close to shops, banks and has excellent access to the parking area.

Rental price: \$14,654.00 + ITBMS

ID de Propiedad	OPANZ19.3.24.1
Área de Terreno	mt ²
Área de Construcción	862 mt ²
Precio	14,654.00
Precio por Área	17.00
Baños	4
Estacionamientos	15

Ubicación



Agente



Zuleyma Montenegro

[+50768184534 \(Llamar\)](#)

[+50768184534 \(WhatsApp\)](#)

info@imperial.com.pa

+50768184534

+50766150060

Fotos



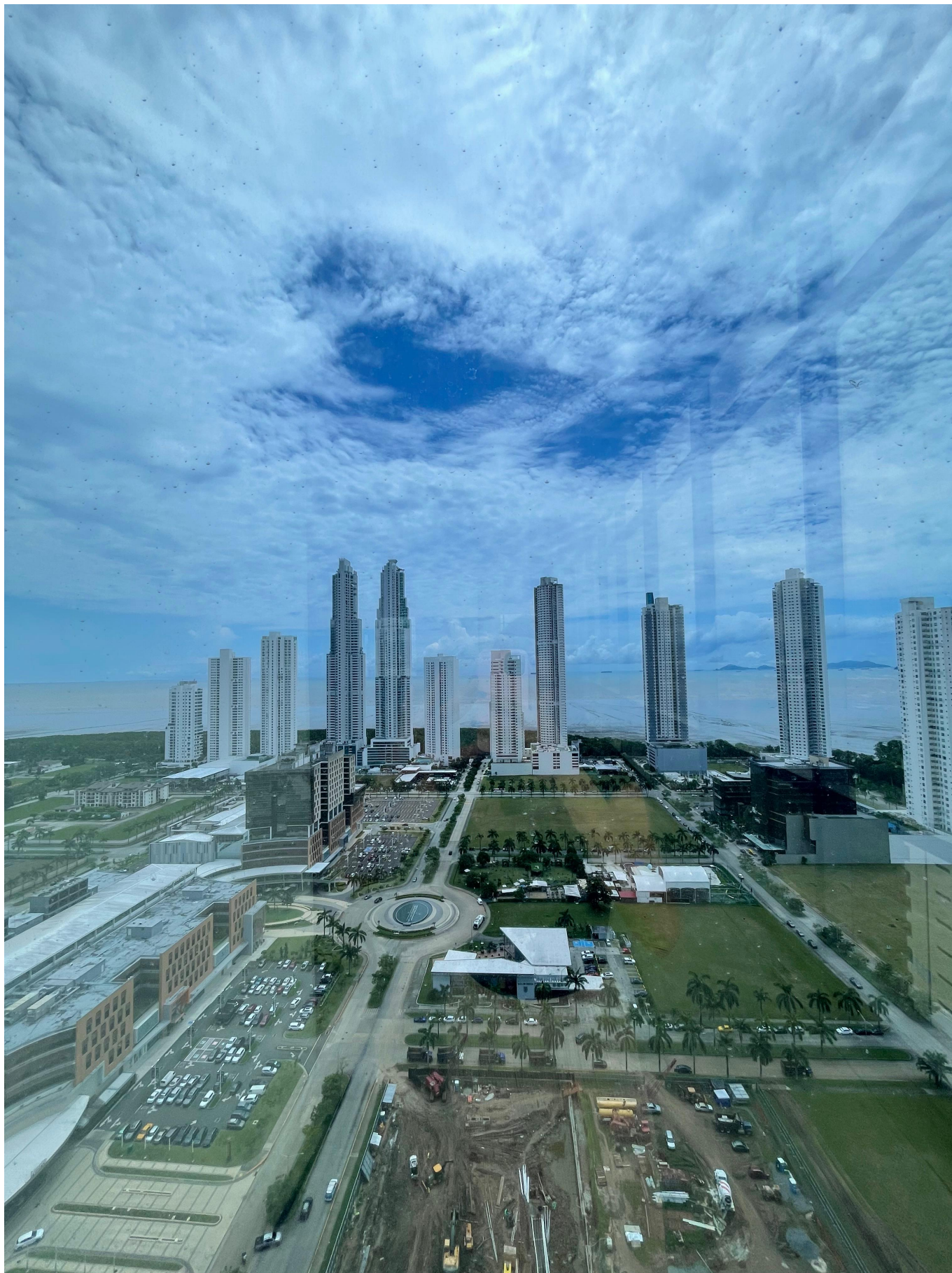





















■ OFICINA A
862m²

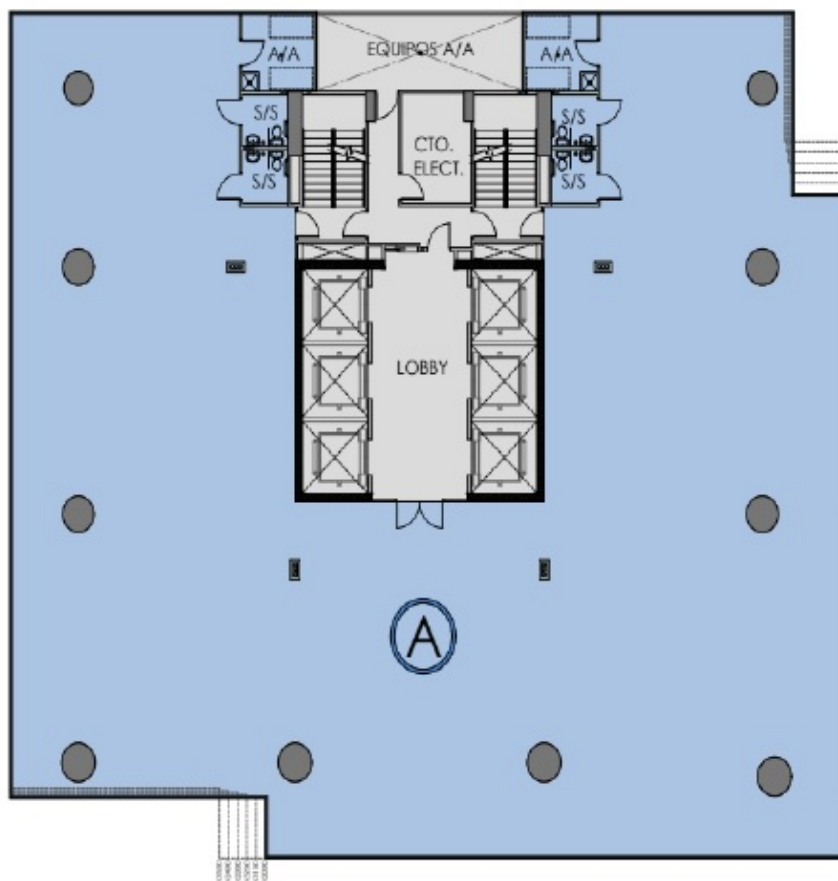

PLANTA TIPICA DE OFICINAS - NIVEL 3000@ 3500









